



PX-S6000

Quick Start Guide

Please keep all information for future reference. Be sure to read the separate "READ THIS!" and use the Digital Piano correctly.

These instructions provide general information about Digital Piano operations. For more detailed information about the product and its operation, visit the CASIO website. Available Information: User's Guide, MIDI Implementation, etc. <https://support.casio.com/global/en/emi/manual/PX-S6000/>



Included Accessories

- Sustain pedal (SP-3)
 - Music Stand
 - AC adaptor (AD-E24250LW)
 - Power cord
 - Wireless MIDI & audio adaptor
 - Leaflets
 - READ THIS! Sheet
 - Other (Warranty, etc.)
- Items included as accessories are subject to change without notice.

Separately Available Accessories

You can get information about accessories that are separately available for this product from the CASIO catalog available from your retailer, and from the CASIO website. <https://support.casio.com/global/en/emi/manual/PX-S6000/>



- Any reproduction of the contents of this manual, either in part or its entirety, is prohibited. Except for your own, personal use, any other use of the contents of this manual without the consent of CASIO is prohibited under copyright laws.
- IN NO EVENT SHALL CASIO BE LIABLE FOR ANY DAMAGES WHATSOEVER (INCLUDING, WITHOUT LIMITATION, DAMAGES FOR LOSS OF PROFITS, BUSINESS INTERRUPTION, LOSS OF INFORMATION) ARISING OUT OF THE USE OF OR INABILITY TO USE THIS MANUAL OR PRODUCT, EVEN IF CASIO HAS BEEN ADVISED OF THE POSSIBILITY OF SUCH DAMAGES.
- The contents of this manual are subject to change without notice.

Connecting with External Devices

Ensure this Digital Piano is turned off before plugging in or unplugging any devices.

Back

USB flash drive (commercially available)

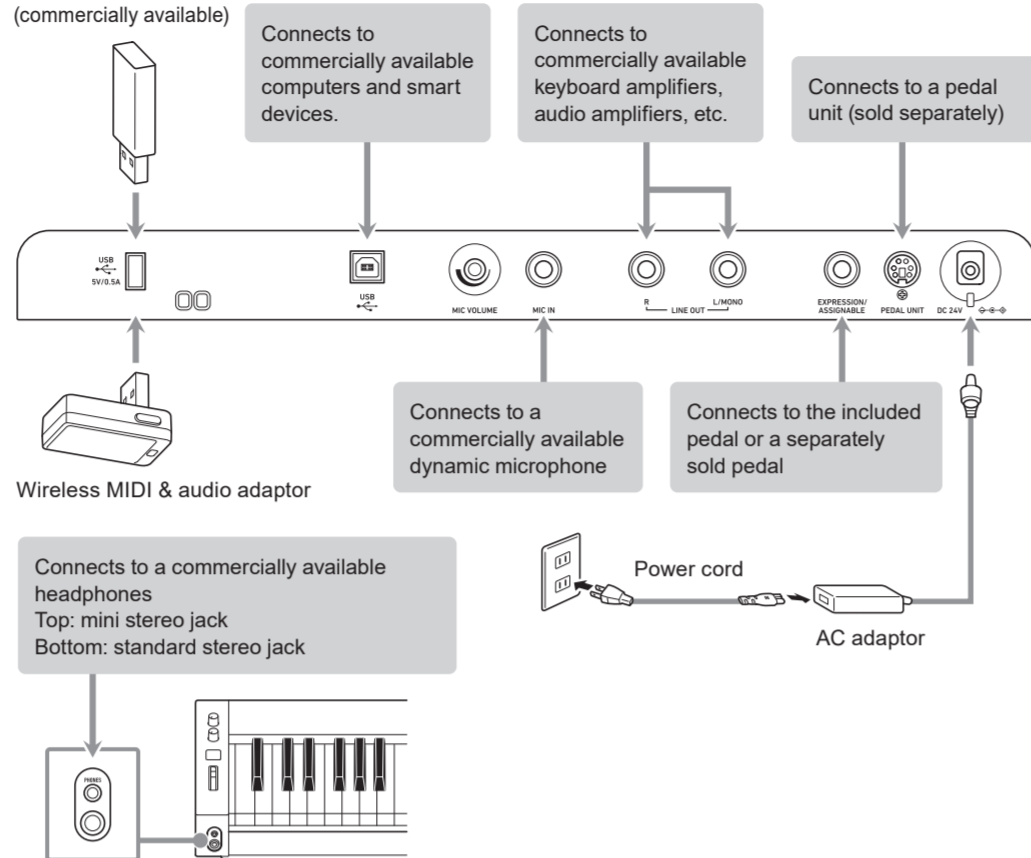

Power On Alert

When this Digital Piano is powered by the AC adaptor and has been inactive for approximately 6 minutes, the buttons on the front panel of this Digital Piano will turn on and off in sequence to inform you that you may have forgotten to turn off the power.

General Guide

This section describes the functions of all parts of the front panel.

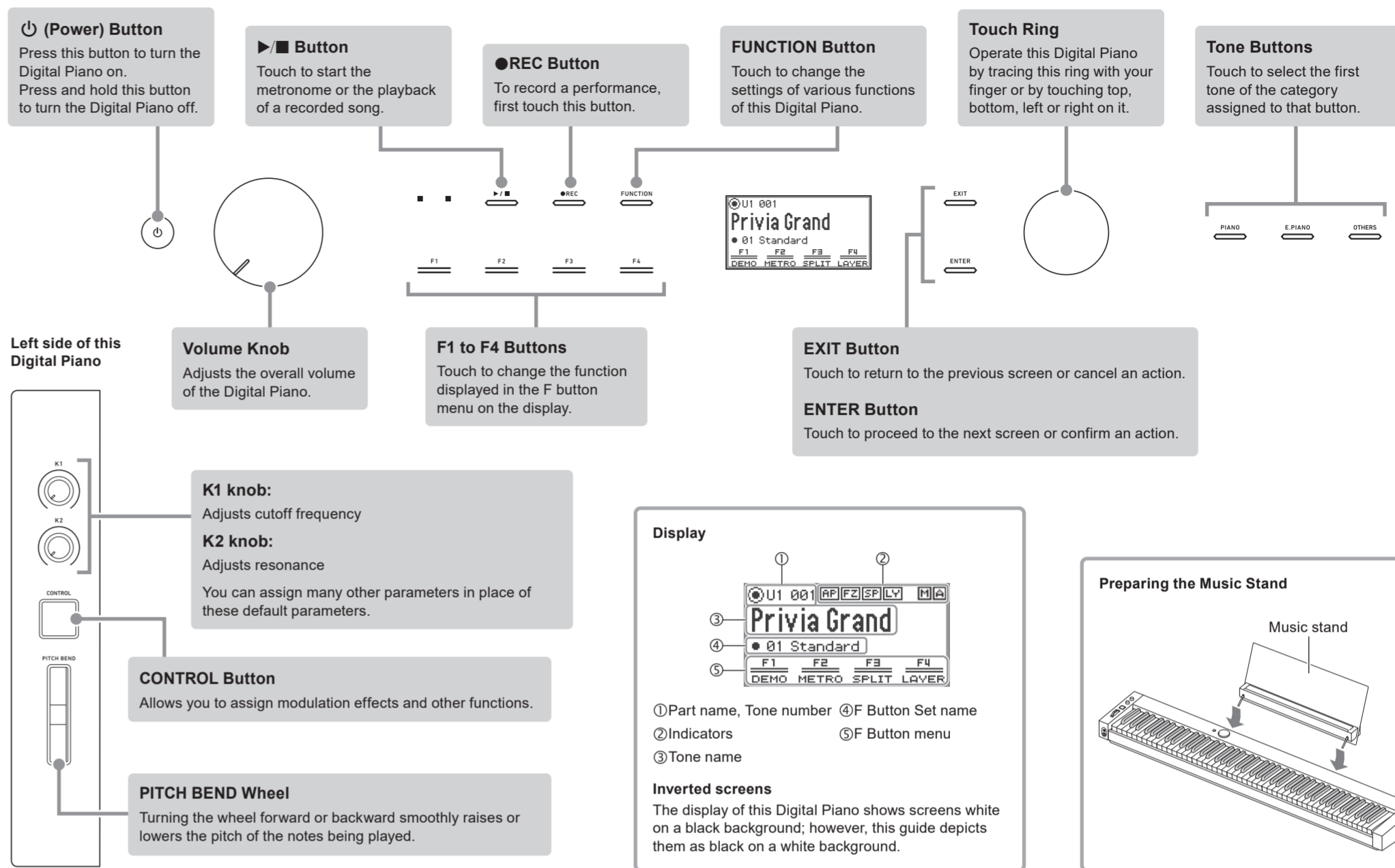

● For detailed information on how to use each function, refer to the "User's Guide" on the CASIO website.

Touch Operation and Notation Used in this Guide

This operation	is shown like this
Touch and immediately release the button	
Hold the button down for about 2 seconds and then release it	
Touch and immediately release the top, bottom, left or right edge of the touch ring	
Trace the circumference of the touch ring with your finger in a counterclockwise or clockwise direction	
Touch and immediately release the F1 button	

F Button Menu on the display:

(DEMO)

Common Basic Operations

Please refer to the following to develop a good grasp of how to operate this Digital Piano!

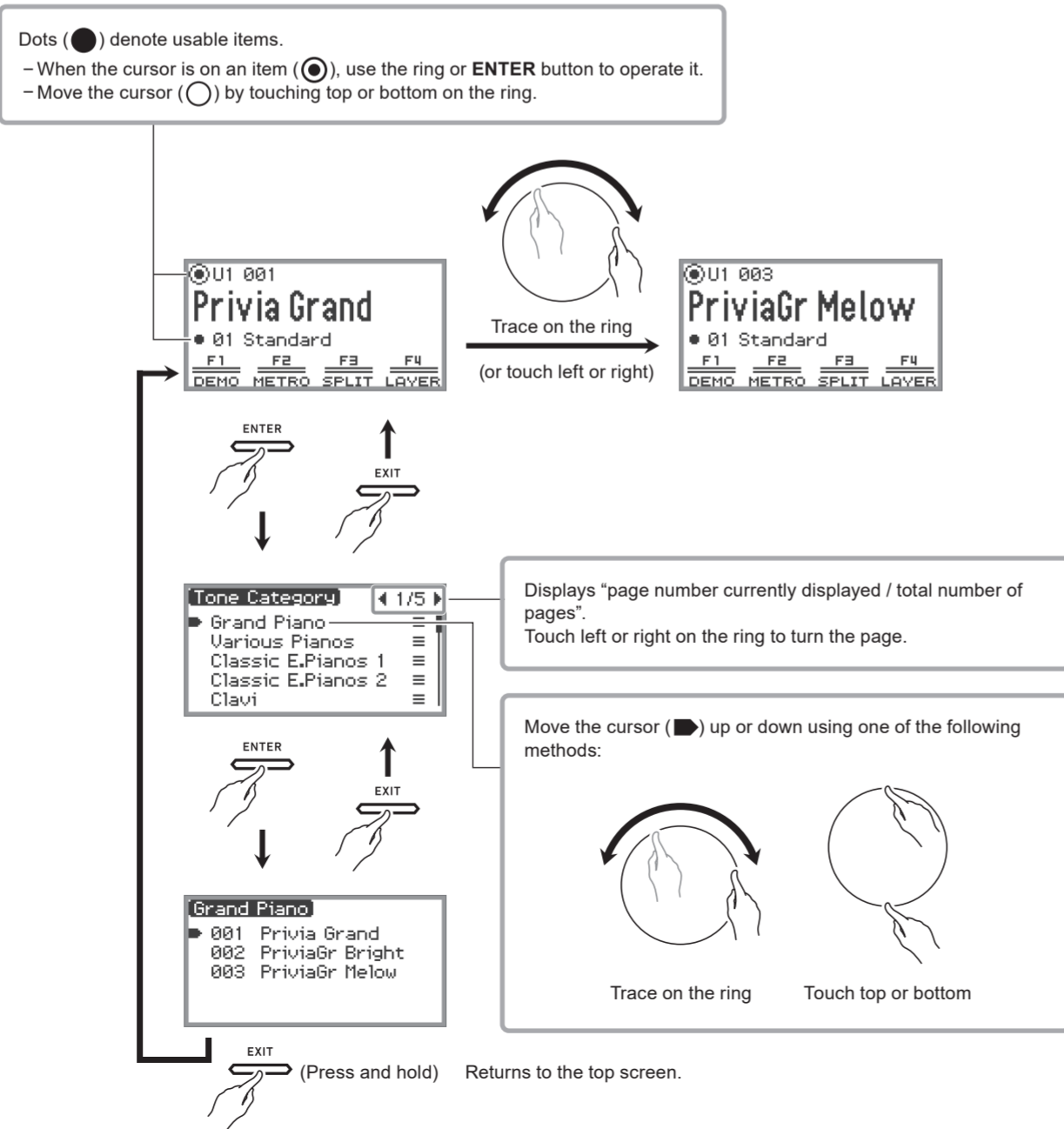

F Button Menu

■ The F Button Menu on the display corresponds to the F buttons (F1 to F4).

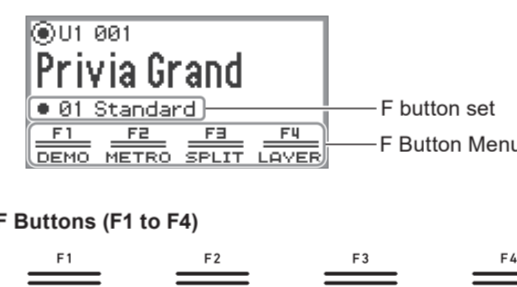

■ Changing the F button set (01, etc.) switches the F button menu.

① Touch top or bottom on the ring to move ○ to the F button set row.

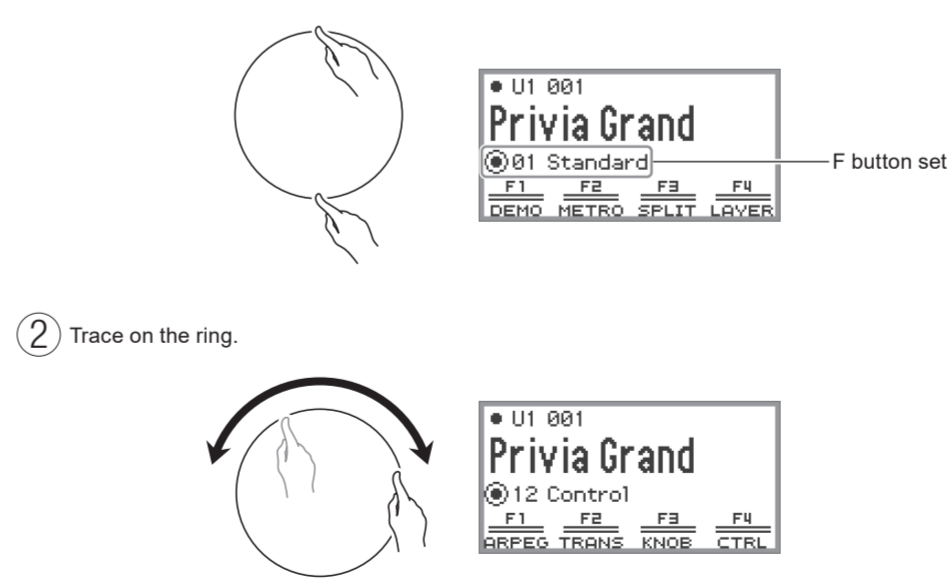

Selecting and Playing a Tone

① Touch top or bottom on the ring to move ○ to the Part Name and Tone Number row.

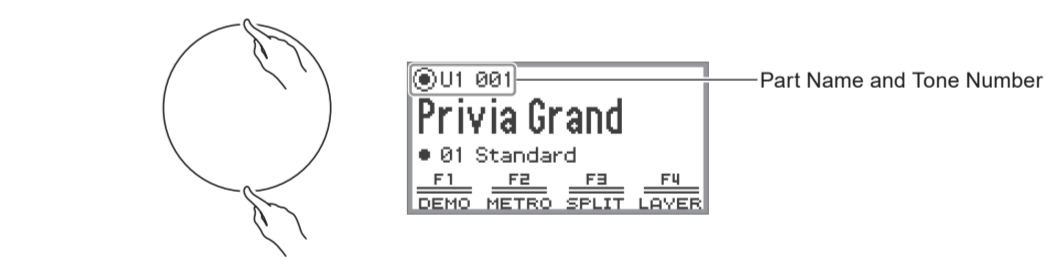

Selecting a Tone Sequentially

② Trace on the ring.

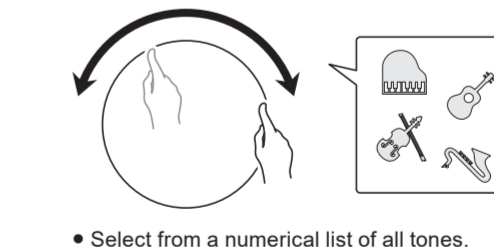

Selecting a Tone by Category

② Touch the ENTER button.
● A list of tone category names appears.

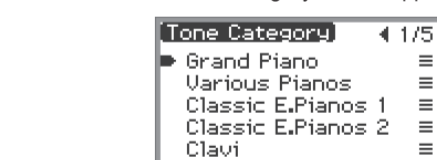

③ Trace on the ring to select a tone category, then touch the ENTER button.
● A list of tone names appears.



④ Trace on the ring to select a tone, then touch and hold the EXIT button.

Playing with a Different Sound

- Select the "01 Standard" F button set. F Button Menu



To play with two layered tones



To change the keyboard's upper-range and low-range tones



- Select the tone you want to layer. Selecting and Playing a Tone

- Select the tone for the lower range of the keyboard. Selecting and Playing a Tone

Listening to Demo Play

- Select the "01 Standard" F button set. F Button Menu

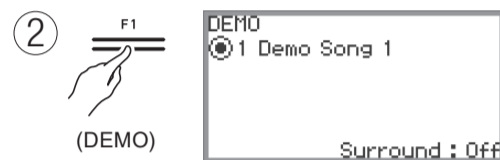

- Start the demo performance.
 - Each touch of the toggles between pausing and resuming the demo performance.

- (Press and hold) Exit DEMO mode.

Using a DSP

You can apply various DSP effects (equalizer, limiter, etc.) to any tone.

- Select the F button set "10 Effect". F Button Menu

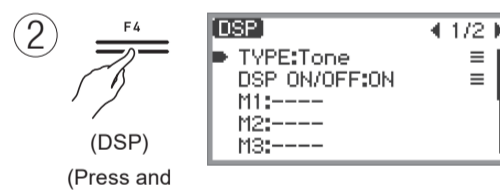

- Trace on the ring to select the desired type of effect, and then touch the **EXIT** button.

- When "DSP ON/OFF:OFF" is displayed, switch to ON.
- (Press and hold) Exit settings.

- Touch the **ENTER** button to display the "TYPE" screen.

Adjusting Acoustic Piano Sound Characteristics (Acoustic Simulator)

You can use the Acoustic Simulator feature to adjust acoustic piano sound characteristics (such as string resonance, damper noise, etc.). To use this feature, select the F button set "09 Favorite Piano" and then touch the **F1** button (ACSIM).

Recording Your Performance (MIDI Recorder)

- End the recording.



- Play back the recorded performance.

NOTE

- The default recording setting is MIDI recorder (which records the performance as MIDI data). You can also switch to an audio recorder, which records audio data as is and includes audio input from the MIC IN jack.
- This Digital Piano enters SONG mode when playing back the recording. SONG mode also enables playback of MIDI data (SMF, CMF and MRF) from the Digital Piano's memory or USB flash drive, and audio data (WAV and MP3) from the USB flash drive.

Sounding the Metronome

- While holding down the **FUNCTION** button, touch the button.

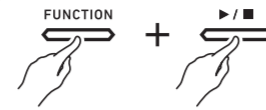

The metronome starts.
 • Stop the metronome in the same manner.

NOTE

- When the "01 Standard" F button set is selected, touch **F2** button (METRO) to set the tempo and the Guide Type for the metronome (normal metronome sound, drum pattern, etc.).

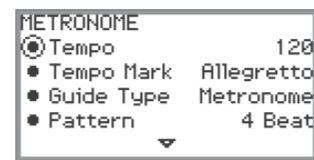

To sound arpeggio automatically (Arpeggiator)

- Select the F button set "12 Control". F Button Menu



- Play and hold a chord (or single note) on the keyboard. An arpeggio pattern plays.

- (ARPEG) Exit the arpeggiator.

Saving and Recalling Performance Setups (Registration)

This Digital Piano can register a maximum of 96 setups (24 banks x 4 areas) for tones, effects, etc.

Saving a Setup Registration

- Select the F button set "02 Regist Setting". F Button Menu



- Trace on the ring to select a bank, then touch .



- Select the area to save. Touch one of them

- Touch right (YES) on the ring to save the setup.

Recalling a Setup Registration

- Select the F button set "03 Registration". F Button Menu

- Select the area of the setup registration you want to recall. Touch one of them

- This recalls the area of the currently selected bank (01 to 24).

Using the Sound Mode

Sound Mode lets you apply two effects to the sound output from this Digital Piano.

Hall Simulator/Reverb

Hall Simulator and Reverb are both type of effects that add reverberation to the sound. Select from the following types: Preset type for the selected tone, concert hall simulation type, type that reproduces the reverberation of a specific space.

Surround

A surround effect (an effect that adds breadth to the sound) is applied to the sound output from the built-in speakers.

- (Press and hold)

- Select "SOUND" and then "SOUND MODE".

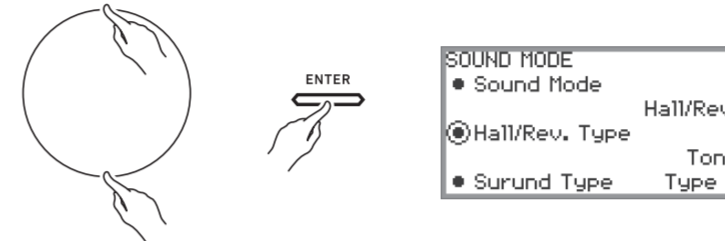

- Change the settings for each item to one of the options displayed on the screen.

Sound Mode	Off: disables both effects Hall/Rev.: enables Hall Simulator/Reverb only Surround: enables Surround only Hall/Rev. + Srnd: enables both effects
Hall/Rev. Type	Tone: the initial setting of each tone Salon - British Stadium: the Hall Simulator options Room 1 - Stadium: the Reverb options
Surround Type *	Type 1: minimum effect depth Type 2: intermediate effect depth Type 3: maximum effect depth

* It may become hard to recognize the effect depending on the tone selected or the audio characteristics being played back.

- (Press and hold) Exit settings.

Using the Mixer

You can configure detailed settings for volume, stereo position and how effects are applied for each part.

- Select the F button set "04 Listening". F Button Menu



Using the Included Wireless MIDI & audio adaptor

Connecting this adaptor to the Digital Piano enables the following. For more information, refer to the "User's Guide" on the CASIO website.

- Playing sound through the Digital Piano's speakers from smart devices connected via Bluetooth
- Connecting with Bluetooth Low Energy MIDI to use the CASIO smart device app

Specifying the Battery Type

Select the battery type that matches the battery installed in this Digital Piano's battery case.

- (Press and hold)

- Select "SYSTEM" and then "Battery Type".

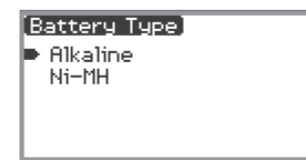

Alkaline: Alkaline battery
 Ni-MH: Rechargeable nickel-metal hydride battery

- Touch top or bottom on the ring to select the battery type.
- (Press and hold) Exit settings.

- When using this Digital Piano on battery power, songs or recordings played at high volume may sound distorted. This is a result of the power supply differences between the AC adaptor and battery power and is not a malfunction. If sound distortion is a concern, please use the AC adaptor or turn down the volume.

Setting the Piano Position

Choose the acoustics to match the Digital Piano's positioning in the room.

- Select the F button set "04 Listening". F Button Menu



Select a setting you like in accordance with the Digital Piano's actual positioning.
 Standard: Standard setting when the Digital Piano is on a stand.

Wall: Recommended setting when the back of this Digital Piano is against a wall.

Center: Recommended setting when this Digital Piano is in the center of a room.

Table: Standard setting when the Digital Piano is placed on top of a table.

- Trace on the ring to select the most appropriate setting for the Digital Piano's positioning.

- (Press and hold) Exit settings.

Using Microphone Effects

You can apply various effects to sound input from the microphone.

- Select the F button set "05 Song Play". F Button Menu

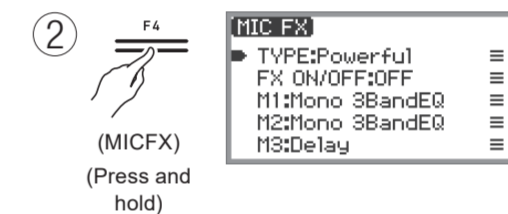

- Trace on the ring to select the desired type of effect, and then touch the **EXIT** button.

- When "FX ON/OFF:OFF" is displayed, switch to ON.
- (Press and hold) Exit settings.

- Touch the **ENTER** button to display the "TYPE" screen.

Returning the Digital Piano to Its Factory Default Settings

This function resets all internal content of the system such as data and settings and returns this Digital Piano to factory default settings.

- (Press and hold)

- Select "SYSTEM" and then "Factory Reset".



- Touch right (YES) on the ring to return this Digital Piano to the factory default settings, or touch left (NO) on the ring to cancel the operation.

Main Specifications

Model: PX-S6000BK

Keyboard: 88-key

Acoustics: Amp output: 8W x 2 + 8W x 2
 Speakers: 16cm x 8cm (oval) x 4

Power Supply: AC adaptor (AD-E24250LW), 8 AA-size alkaline batteries or AA-size rechargeable nickel metal hydride batteries

Power consumption: 24V ~ 20W

Dimensions: 134.0(W) x 24.2(D) x 10.2(H) cm (53 3/4 x 9 1/2 x 4 inch)

Weight: Approximately 14.8 kg (32.6 lbs) (Excluding batteries)

• Specifications and designs are subject to change without notice.

Declaration of Conformity

Model Number: PX-S6000
 Trade Name: CASIO COMPUTER CO., LTD.
 Responsible party: CASIO AMERICA, INC.
 Address: 570 MT. PLEASANT AVENUE, DOVER, NEW JERSEY 07801
 Telephone number: 973-361-5400

This device complies with Part 15 of the FCC Rules. Operation is subject to the following two conditions:
 (1) This device may not cause harmful interference, and (2) this device must accept any interference received, including interference that may cause undesired operation.

A labels rating is affixed to the right side of the product.

CASIO COMPUTER CO., LTD.
 6-2, Hon-machi 1-chome
 Shibuya-ku, Tokyo 151-8543, Japan