

Operation Guide 5722

CASIO®

You can also find information about operational procedures at the CASIO website.

<https://s.casio.jp/mw/en/5722/>



- Your watch may differ somewhat from the one shown in the illustration.

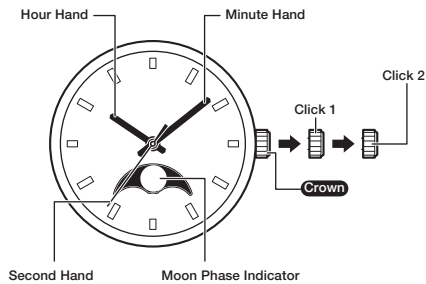

Crown Operations

Some water-resistant models (10BAR, 20BAR) have a screw-in crown. When you need to perform a crown operation, rotate it towards you to unscrew it. Then pull the crown out. Avoid applying undue force when pulling. The watch loses its water resistance while the crown is unscrewed. After performing a crown operation, fully screw the crown back in.

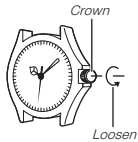

If your watch has a rotary bezel...

You can rotate the bezel to align its ▼ mark with the minute hand. Then you will be able to tell how much time has elapsed since aligning the ▼ mark.

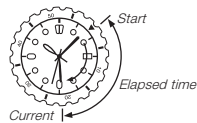

Specifications

Accuracy at normal temperature (per month)	Battery type	Battery life
±20 seconds	SR621SW	Approx. 3 years

Specifications are subject to change without notice.

To adjust the time setting

When the second hand is at 12 o'clock, pull the **Crown** out to Click 2.

Rotate the **Crown** to change the time setting.

Push the **Crown** back in on a time signal to resume timekeeping.

Note

- Take care that you set the correct AM or PM time. Moon Phase indicator is performed by around 2:00 a.m. Make sure you distinguish between AM and PM.
- When changing the time, move the minute hand four or five minutes past your final setting, and then back it up to the setting you want.

Setting the Moon Age

The Moon goes through a regular cycle of approximately 29.5 days during which it appears to wax and wane due to how it is illuminated by the Sun, and the relative positioning of the Earth, Moon, and Sun.

The greater the angular distance between the Moon and the Sun,* the more of the Moon we see illuminated.

* The angle to the Moon in relation to the direction at which the Sun is visible from the Earth.

Moon Phase Indicator

The Moon phase indicator of this watch indicates the current phase of the Moon as shown below.

Moon Phase Indicator				
Moon Age	0	7	15	22
Moon Phase	New Moon	First Quarter (Waxing)	Full Moon	Last Quarter (Waning)

- The Moon phase indicator shows the Moon as viewed at noon from a position in the Northern Hemisphere looking south. Note that at times the image shown by the Moon phase indicator may differ from that of the actual Moon in your area.
- The left-right orientation of the Moon phase is reversed when viewing from the Southern Hemisphere or from a point near the equator.

Setting the Moon Age

Pull the **Crown** out to Click 1.

Rotate the **Crown** away from you until the Moon phase indicator shows the correct Moon phase.

- For details about Moon phases, see "Moon Phase Indicator" above.

Push the **Crown** back in.

